

NCVH 2026

New Cardiovascular Horizons

Industry Prospectus
Invest Wisely NCVH.org

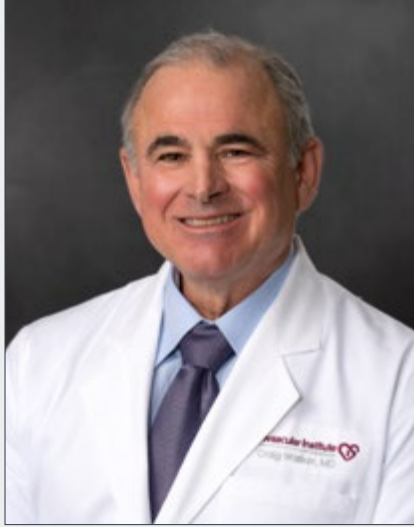



Craig M. Walker, MD

Clinical Professor of Medicine
Tulane University School of Medicine
New Orleans, LA

Clinical Professor of Medicine
LSU School of Medicine
New Orleans, LA

Founder, President and
Medical Director
Cardiovascular Institute
of the South
Houma, LA

Chief Medical Officer
Cardiovascular Logistics

Editor in Chief
JAVELIN Journal

Clinical Editor
Vascular Disease Management

Message from the Founder

I would like to invite you to join us as a sponsor for the upcoming 27th Annual NCVH (New Cardiovascular Horizons) conference, one of the premier gatherings in the field of endovascular and cardiovascular care.

With over 1,300 healthcare providers in attendance, including many of the highest-volume endovascular operators in North America, NCVH offers a unique opportunity to engage directly with a highly specialized and influential audience. As always, our world class education is delivered by world class faculty. Our 27th Annual conference will continue to offer the curriculum and live cases that have made NCVH a can't miss event.

Supporting NCVH is more than just an investment in visibility; it's a chance to become an integral part of a collegial family dedicated to advancing patient care. Our conference culture is inviting and collaborative, fostering meaningful connections between sponsors and clinicians. We recognize industry as key contributors to our shared mission, and we are committed to ensuring that your experience with us is impactful, rewarding, and celebrated as part of the greater effort to improve outcomes for patients worldwide.

Thank you for considering NCVH as part of your sponsorship plans. I look forward to the possibility of welcoming you to our community and to an event that promises to inspire and innovate.

A handwritten signature in black ink that reads "Craig M. Walker MD". The signature is written in a cursive, flowing style.

Chairman
New Cardiovascular Horizons

Table of Contents

About Us

Message from the Founder	1
Vice Chairman, Conference Co-Chairmen and Course Directors	3
Who Attends	4
26 th Annual Conference Sponsors	5

Important Dates

Program Schedule, Exhibitor Timeline, Exhibit Hours, Hotel Reservations	6
---	---

Fellows Course

Business Of Medicine	8
-----------------------------	---

Premier Sponsor Packages

Exhibit Rates	10
Meal Symposia	11
Exhibit Floor Plan	12
Hotel Floor Plan	13
High Traffic Signage	14
Digital Display Opportunities	15
Mobile App	16
Email and Social Media Marketing Opportunities	17
Daily Newspaper	18
Conference Bag	19
Promotional Advertising Opportunities	20
Annual Conference Program	21
Hotel Promotional Advertising Opportunities	22
Hotel Meeting Room Rental Rates	23

Orpheum Theater Advertising Opportunities

Logistics

Shipping Services	
Electrical and Internet	
Audiovisual Services	
Lead Retrieval	
Hotel Shipping	
Exhibit Hall and Booth Specifications	

Exhibit Rules and Regulations

Application and Contract



Vice Chairman

Pradeep Nair, MD
Cardiovascular
Institute of the South
Houma, LA

Conference Co-Chairmen

Amit Amin, MD
Cardiovascular Institute of the South
Lafayette, LA

Robert Beasley, MD
Palm Vascular Centers
Miami Beach, FL

Eric Dippel, MD
Vascular Institute of the Midwest
Davenport, IA

Erica Fidone, MD
Woodland Heights Medical Center
Lufkin, TX

Matthew Finn, MD
Cardiovascular Insititue of the South
Houma, LA

Osama Ibrahim, MD
Cardiology and Vascular Associates, LLC
Tullahoma, TN

Richard Kovach, MD
Deborah Heart
Browns Mills, NJ

Ankur Lodha, MD
Cardiovascular Institute of the South
Lafayette, LA

Frank Tursi, DPM
Our Lady of Lourdes Medical Center
Voorhees, NJ

Mary Yost, MBA
The Sage Group
Beaufort, SC

Conference Course Directors

George Adams, MD
North Carolina Heart & Vascular
Rex Healthcare
Raleigh, NC

S. Hinan Ahmed, MD
Methodist Healthcare
San Antonio, TX

Mohammad (Mac) Ansari, MD
University of Houston
Houston, TX

Robert Coronado, MD
Coronado Vein Center
Redding, CA

Jeff Davis, RRT, RCIS
Florida SouthWestern State College
Fort Myers, FL

Thomas Davis, MD
St. John Hospital and Eastlake
Cardiovascular
St. Clair Shores, MI

Eoin Donnellan, MD
Cardiovascular Institute of the South
Lafayette, LA

W. Britton Eaves, MD
Willis Knighton Cardiology
Bossier City, LA

Satish Gadi, MD
Cardiovascular Institute of the South
Baton Rouge, LA

John Galla, MD
Cardiology Associates
Mobile, AL

Mark Goodwin, MD
Midwest Cardiovascular Institute
Naperville, IL

Ryan Hebert, MHA, RT (R)
Cardiovascular Institute of the South
Houma, LA

S. Jay Mathews, MD, MS
Bradenton Cardiology Center
Bradenton, FL

Owen Mogabgab, MD
Cardiovascular Institute of the South
Harvey, LA

Jihad Mustapha, MD
Michigan State University
East Lansing, MI

Fadi Saab, MD
MOVI: Michigan Outpatient
Vascular Institute
Dearborn, MI

Vinay Satwah, DO
Center for Vascular Medicine
Greenbelt, MD

Jasvinder Singh, MD
Washington University School of Medicine
St. Louis, MO

David Slovut, MD, PhD, MHA
HCA Florida Oak Hill Hospital
Brooksville, FL

Ariel Soffer, MD
Soffer Health
Aventura, FL

Anish Thomas, MD
Mercy Hospital South
St. Louis, MO

McCall Walker, MD
Cardiovascular Institute of the South
Houma, LA



**Total NCVH Event Attendees
2,839**

- 97% North America
- 1% EU
- 1% Asia
- 1% South America

MD, DO 43%

- DPM 8%
- PA, NP, RN 18%
- Allied Health 21%
- Technologists 10%

Who Attends

For twenty-seven years, NCVH has attracted a large group of multidisciplinary healthcare professionals. NCVH Chairs, Co-Chairs, and Course Directors comprise a highly respected physician and allied healthcare group. They represent the highest volume interventionalists practicing in North America and the most sought-after researchers for trials and research studies. NCVH also has a large international following enhancing its commitment to education for better patient outcomes worldwide.

In addition, NCVH boasts a diverse group of physicians and healthcare professionals representing our multi-cultural community who bring personal perspectives on how we, as healthcare professionals, grapple with the disparities faced across gender and ethnic groups.

NCVH remains focused on developing the next generation of interventionalists. The 15th Annual NCVH Fellows Course will build on the success of previous years and improve upon its success.

The new NCVH Fellows competition, cadaver lab, hands-on workshops, and specialized Fellows networking opportunities will grow the 15th NCVH Fellows program to new heights.



**12 NCVH Regional Meetings
in North America**

- Gulf Coast (Mobile, AL)
- Shreveport, LA
- New York, NY
- Davenport, IA
- Baton Rouge, LA
- New Jersey (Atlantic City)
- South Florida (Miami)
- Lafayette, LA
- Chicago, IL
- Nashville, TN
- St. Louis, MO
- Tampa, FL

Valued Partnership

New Cardiovascular Horizons offers a unique, inclusive conference experience for all supporting sponsors. NCVH conference leadership recognizes that industry partners are critical to the educational process.

Industry Partners are included as faculty in many NCVH sessions, sit on panel discussions, lead symposia, and interact with all conference attendees in sessions and social events. Involving Industry partners in the entire conference experience builds the relationships that foster true innovation and drive meaningful improvements in patient outcomes. We look forward to your support and participation in the NCVH experience.

26th Annual Conference Sponsors

PLATINUM			
GOLD			
SILVER			
BRONZE			

Supporters

Abbott	Imperative Care Vascular	Shockwave Medical
ACIST Medical Systems	Inari Medical	Superscript
AIROS Medical	IronRod Health	Surmodics, Inc.
Alnylam Pharmaceuticals	Johnson & Johnson MedTech, Heart Recovery	Tactile Medical
Amgen	Kaneka - LIPOSORBER	Teleflex
AngioAdvancements	Kestra Medical Technologies	Terrebonne General Health System
AngioDynamics, Inc.	Kiniksa Pharmaceuticals	TLS Global Group
Argon Medical Devices	Medtronic	Versono
BD Peripheral Intervention	Merck and Company, Inc.	Veryan Medical Ltd
Biotronik, Inc.	Micro Medical Solutions, Inc.	Vesalio
Boehringer Ingelheim Pharmaceuticals, Inc.	Mindray	ZOLL
Brosmed	Nipro Medical Corporation	
Canon Medical Systems USA, Inc.	Novartis Pharmaceuticals Corporation	
Cardio Health Solutions	Ochsner Lafayette General	
Cardiovascular Institute of the South	Octagos	
Cardiovascular Logistics	Pfizer Internal Medicine	
Cook Medical	Radux Devices, LLC	
CureTech	Rao Clinic	
Endologix LLC	Recor Medical	
GE HealthCare	Reflow Medical	
Haemonetics	Salus Scientific Corp.	
Horizon Solutions	Shimadzu Medical Systems	

Commercial Support

Abbott
Abiomed
Cook
Gore
Medtronic
Philips
Shockwave
Terumo

Important Dates

Program Schedule

Tuesday, May 26	15 th Annual Fellows Course, Lectures and Live Cases
Tuesday, May 26	10 th Annual Business of Medicine
Tuesday, May 26	Meet The Titans Reception - Blue Room, Lobby Level
Wednesday, May 27	Fellows Course Hands-on Workshops - Chambers Level
Wednesday, May 27	General Session, Podiatry & Wound Care, Healthcare Professionals
Thursday, May 28	General Session, Family Practice, Podiatry & Wound Care, Healthcare Professionals
Friday, May 29	General Session, Podiatry and Wound Care, Healthcare Professionals

Exhibitor Timeline *Dates are subject to change by Freeman Exhibitor Services

Tuesday, March 31	Final Payments Due (Must be Received Prior to Move-in)
Wednesday, April 1	10% Late Fee Begins
*Monday, April 27	Warehouse Receiving Starts
*Wednesday, April 29	Furnishings Advanced Pricing Deadline
Friday, May 1	Print and Digital Materials Due
Friday, May 15	Conference Bag Inserts Due (Shipments Received After Due Date May Not be Included)
Tuesday, May 19	Name Badge Deadline
*Friday, May 22	Warehouse Receiving Deadline

Exhibit Hours

*A "Hand Carried" item is defined as what one person can carry in one trip without a hand-truck or bellman's cart. Booth tear-down must be contained to the booth and cannot protrude into the aisles.

Tuesday, May 26	9:00 AM - 5:00 PM	Exhibitor Move-In
Wednesday, May 27	9:00 AM - 4:00 PM	Exhibit Hall Open
Thursday, May 28	9:00 AM - 4:00 PM	Exhibit Hall Open
Friday, May 29	9:00 AM - 4:00 PM	Exhibit Hall Open
*Friday, May 29	4:00 PM - 6:00 PM	'Hand-Carry' ONLY Exhibitor Move-Out
Friday, May 29	6:00 PM - 8:00 PM	Exhibitor Move-Out

Hotel Reservations: The Roosevelt Hotel

Discount Deadline: May 1, 2026

\$299/night + tax and fees

ncvh.org/travel

*Additional rules apply for large room blocks

Pan Am Travel:

Kathy Tigno

(949) 614.8014

kathy.tigno@panamtravel.com



NCVH Fellows Course \$40,000

Tuesday, May 26 and Wednesday, May 27

NCVH is making significant updates to its Fellows Course.

Join us in New Orleans for an educational experience designed to inspire, engage, and prepare the next generation of vascular specialists. Full scholarships are available to late year medical students, residents, and fellows with the goal of introducing early career physicians to the specialty and advancing their endovascular skills.

The attendees will be assigned across dual tracks based upon their experience enabling faculty and hands on proctors to gear exercises matching the level of attendee experience.

Key Course Highlights:

- Didactic Training Day: A full day of lectures and interactive sessions led by renowned faculty, providing attendees with cutting-edge knowledge and practical insights into peripheral vascular interventions.
- Live Case Presentation: A real-time demonstration of a peripheral vascular intervention, highlighting best practices and innovation in clinical care.
- Hands on Cadaver Lab
- Hands on Training Rotations: Scheduled rotations where fellows work directly with industry partners, offering a unique opportunity to showcase your technologies, products, and expertise.

Sponsorship Benefits:

- Direct Access to Current and Future Leaders
- Showcase Your Expertise
- Networking Opportunities

Fellows Course symposium sponsors must also register to be Fellows Course Hands-on supporter.

Lunch Symposium \$25,000

1 available; includes food, beverage and audiovisual.

Dinner Symposium \$25,000

2 available; includes food, beverage and audiovisual.

Breakfast Symposium \$25,000

1 available; includes food, beverage and audiovisual.

Fellows Text Messaging \$2,000

A custom text message sent to attending Fellows.

Sponsorship application, logistics information and additional details at [NCVH.org/fellows-industry/](https://www.ncvh.org/fellows-industry/)



Business of Medicine

Breakfast Symposium \$10,000

Lunch Symposium \$10,000

Stakeholders Forum | Tuesday, May 26

This innovative session continues to draw record audiences. Led by Mary L. Yost, MBA, Co-Chairman, "Understanding the Business of Peripheral Interventions Stakeholders Forum" outlines the comprehensive financial and economic impact of amputations, peripheral interventions, reimbursements and other exciting topics in the ever-changing landscape of today's complex healthcare industry.

Educational Highlights

- The Business of Peripheral Interventions: Why it is essential to every community, hospital, interventional lab and patient.
- Medical intervention: How does new technology affect cost and outcome?
- Early identification of peripheral vascular disease: How does this impact patient outcomes and costs?
- Business aspects of outpatient vascular centers and other practice options.
- Understanding the PVD patient experience.
- Reimbursement, pre-approval, declines and patient care.



Meet the Titans Reception \$10,000

The 10th Annual Meet the Titans of Peripheral Interventions Reception will be held on Tuesday, May 26th, in the Roosevelt's famous Blue Room. The NCVH Fellows Course and the Business of Peripheral Interventions STAKEHOLDERS Forum conclude with this high-energy cocktail party that provides a perfect opportunity to showcase your brand.

Target these healthcare "movers and shakers" in this lively environment.

Includes:

- Brand recognition in e-mail invitation and announcements
- Digital branding in room during event
- Branding on reception items and cocktail napkins
- Brand recognition on print event signage

exhibits@ncvh.org | 337.993.7920

Premier Sponsor Packages

Platinum \$210,000

- 20x20 premium exhibit booth
- Breakfast or lunch symposium (up to 200 attendees)
- 20 exhibitor registrations
- 1 full-page ad in program
- 3 email marketing messages
- 3 conference bag inserts
- Platinum recognition on digital signage
- Social media post to over 30,000+ followers

Gold \$160,000

- 10x20 premium end cap exhibit booth
- Lunch symposium
- 15 exhibitor registrations
- 1 full-page ad in program
- 2 email marketing messages
- 2 conference bag inserts
- Gold recognition on digital signage
- Social media post to over 30,000+ followers



Silver \$110,000

- 8x20 exhibit booth
- Lunch symposium
- 12 exhibitor registrations
- 1 full-page ad in program
- 1 conference bag insert
- Silver recognition on digital signage
- Social media post to over 30,000+ followers



Bronze \$60,000

- 10x10 exhibit booth
- 10 exhibitor registrations
- 1 full-page ad in conference program
- 1 conference bag insert
- Bronze recognition on digital signage
- Social media post to over 30,000+ followers

Exhibit Rates

10x10 Booth \$23,000

- 4 complimentary exhibitor registrations
- 1 Conference bag insert
- 20% discount on advertising opportunities

8x10 Booth \$13,000

- 3 complimentary exhibitor registrations
- 10% discount on advertising opportunities

8x8 Booth \$6,500

- 2 complimentary exhibitor registrations
- **6 available**
- Application acceptance required

Publishers \$1,500

- 1 complimentary exhibitor registration
- Application acceptance required

Non-Profits \$500

- 1 complimentary exhibitor registration
- Application acceptance required

**Larger 10x20 or 8x20 booths are available through Conference Sponsorship packages. Requests for co-joined booths will be prioritized by sponsor level.*

Meal Symposia

View what days are available on page 11

Command full-audience attention for your product-specific educational messages with these in-demand breakfast and lunch symposia opportunities. Contact 337.993.7920 or exhibits@ncvh.org regarding custom options.



Items included

- Room rental
- Food and beverage
- Full-page, 4-color ad in on-site program
- Attendee report with full contact details
- Speaker ready room access and presentation support for the speaker and liaison



Audiovisual Equipment

- Screen, projector, sound system and technician
- Lectern (podium) with microphone
- Confidence monitor with speaker timer
- Four-person head table with two microphones
- Audience Q&A microphone

Meal Symposia

DATE	ITEM	ATTENDEES	ROOM	AMOUNT
Fellows Course				
Tuesday, May 26	Breakfast Symposium	100	Waldorf	\$25,000
	Lunch Symposium	100	Waldorf	\$25,000
Tuesday, May 26	Dinner Symposium	100	Waldorf	\$25,000
Wednesday, May 27	Dinner Symposium	100	Waldorf	\$25,000
Business of Medicine				
Tuesday, May 26	Breakfast Symposium	75	Orpheum	\$10,000
	Lunch Symposium	75	Orpheum	\$10,000
Annual Conference				
Wednesday, May 27	Breakfast Symposium	150	Waldorf	\$30,000
	Lunch Symposium	125	Waldorf	\$30,000
	Lunch Symposium	125	Orpheum	\$25,000
	Lunch Symposium	75	Blue Room	\$25,000
Thursday, May 28	Breakfast Symposium	150	Waldorf	\$30,000
	Lunch Symposium	125	Waldorf	\$30,000
	Lunch Symposium	125	Orpheum	\$25,000
	Lunch Symposium	75	Blue Room	\$20,000
Friday, May 29	Breakfast Symposium	150	Waldorf	\$30,000
	Lunch Symposium	125	Waldorf	\$30,000
	Lunch Symposium	125	Orpheum	\$25,000
	Lunch Symposium	75	Blue Room	\$20,000

Symposium Schedules

Meal symposia content is limited to 45 minutes.

*Breakfast

7:00 AM - 7:30 AM	Breakfast Served
7:05 AM - 7:50 AM	Educational Content Q&A
7:50 AM	Adjourn

*Lunch

12:00 PM - 12:15 PM	Lunch Served
12:10 PM - 12:55 PM	Educational Content Q&A
12:55 PM	Adjourn

**Exact times subject to change.*

Symposium Upgrades

Live Case (Price based on Live Case location) \$5,000 - \$20,000 (estimate)

Symposium Recording \$2,000

Symposium Live Stream Broadcast \$5,000 over internet

Exhibit Floor Plan

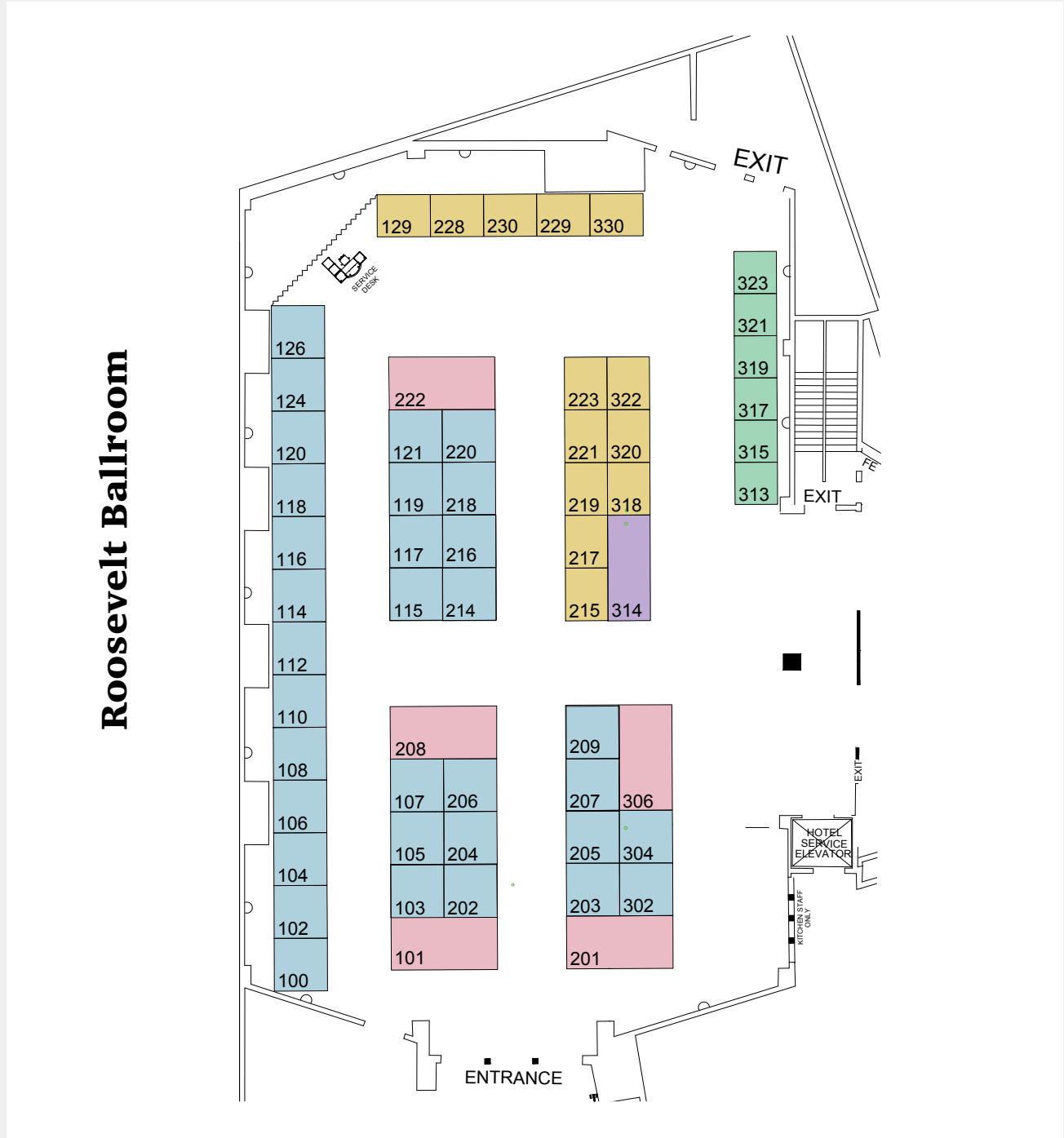

Booth Sizes

- 8x8
- 8x10
- 8x20
- 10x10
- 10x20

This floor plan is subject to minor changes. Space is assigned first come, first serve, based upon receipt of deposit. Please complete booth preference section.

For booth space larger than 10x10, purchase of a premier sponsor package is required.

Hotel Floor Plan

DS - Digital signage locations

1-5 - Locations of High Traffic Signage

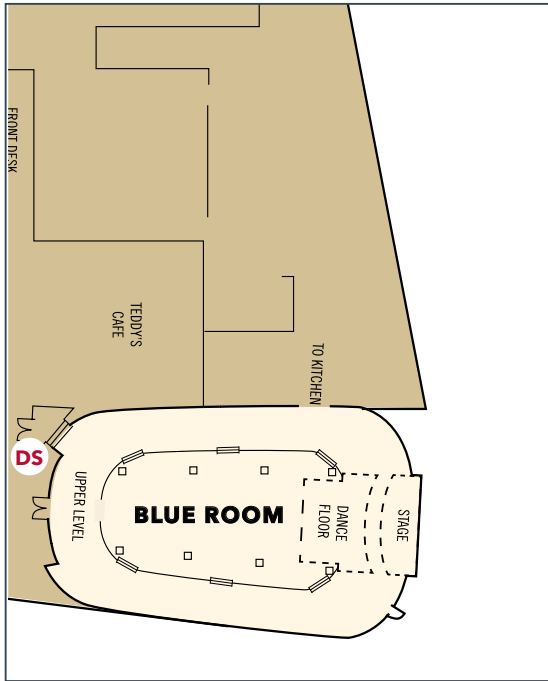

Lobby Level

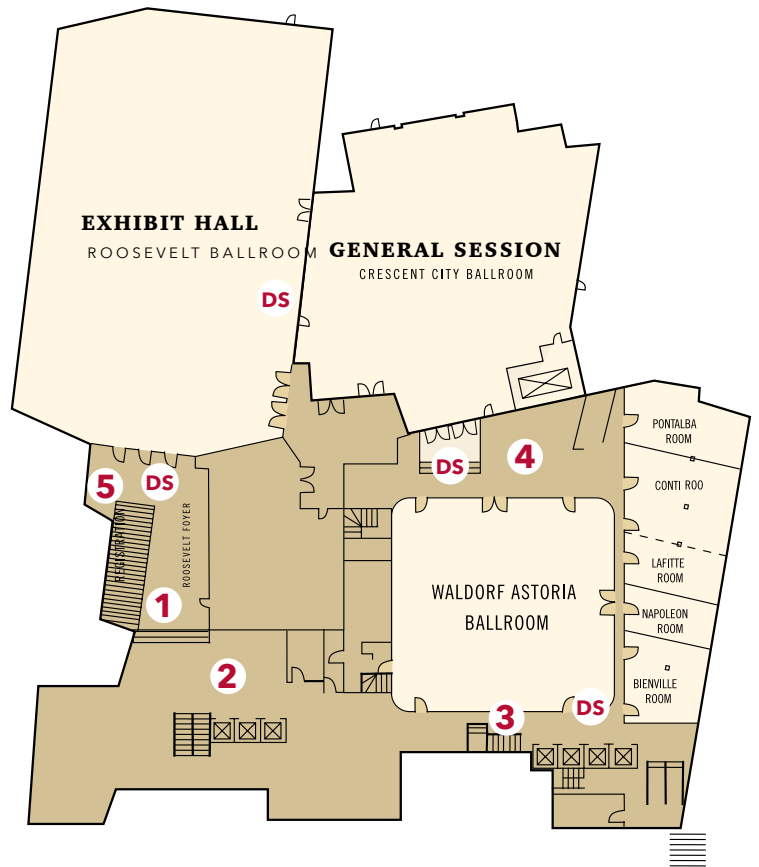

Mezzanine Level

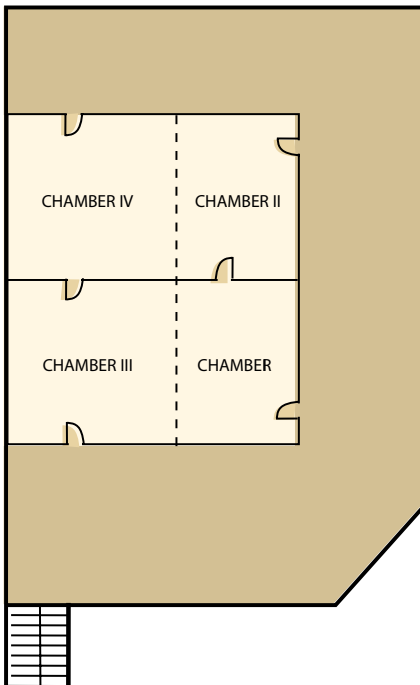

Mayor's Suite Level

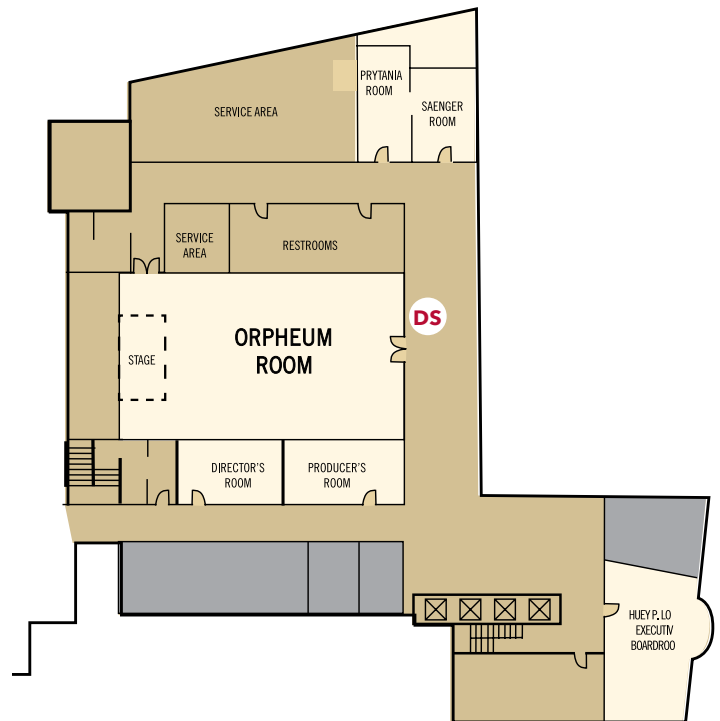

Second Level

High Traffic Signage

Grab the attention of attendees with large format signage in high traffic areas throughout the conference.

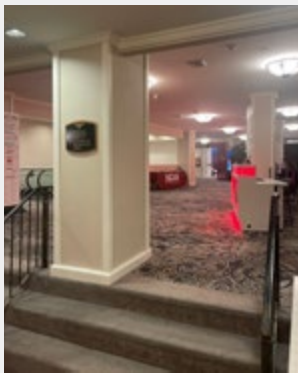

Multi Area Column Wraps \$25,000

Locations Registration Area, Roosevelt Ballroom Foyer, Elevators by Waldorf, General Session Entrance

With four individual locations in the highly traveled corridor between registration, both tower elevators, and meeting rooms, this multi-column branding opportunity extends visibility across conference floor space.



Grand Entrance Column Wrap \$15,000

Location Registration Entrance, Tower One

Located just off the main attendee entrance elevators, this three-sided column wrap offers a high traffic and visibility marketing opportunity.



Staircase Multi-View Signage \$12,000

Location Staircase from Mezzanine Level to Second Level

A unique opportunity to brand the marble staircase leading to the second-floor meeting space from the Mezzanine meeting space. This is

a great location for groups holding private meetings in second floor meeting rooms or lunch symposia in Orpheum Room.

Conference Wi-Fi \$12,000

- Customize network ID
- Customize Password
- Printed signage with sponsorship and log-in information
- Business cards will be placed in high traffic areas that include sponsor logo and login credentials.

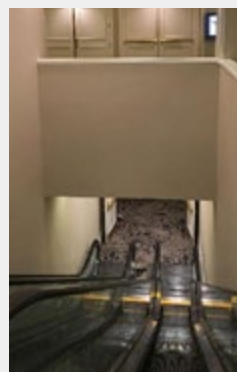

Cloth Banner Hang \$10,000

Location Above Escalators from Mezzanine to Mayor's Suite Level

Located in the conference registration area, this high visibility area provides a place where your brand stands apart in a dedicated space. Just

above the escalators leading to the Chamber Rooms, The Blue Room, and the hotel lobby.

Digital Display Opportunities

Reach attendees throughout the conference space with sponsored messages shown simultaneously on all five digital displays. The displays will be split screen with relevant attendee information such as current agenda schedule, special announcements, live cases, and keynote presentations.

Exhibit Hall Video AD \$5,000

A 30 second full screen video advertisement with audio played across the 16' digital display in the exhibit hall/Roosevelt Ballroom during exhibit breaks or once per hour, whichever is more frequent.

Format: 1920x1080 horizontal

Lecture Branding \$5,000

Place a logo or QR code for participants to scan and get more information regarding a specific lecture topic. QR code with logo will appear as overlay during entire lecture on the exhibit hall digital marquees.

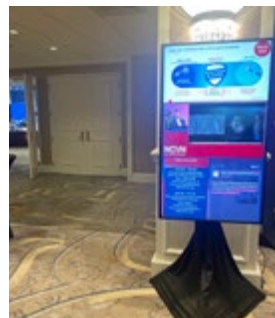

Digital Signage Looping AD \$2,500

A PowerPoint slide or silent video advertisement that loops intermittently for ten seconds across all five displays (60" TVs). Priced per half-day.

***Display: 1920x1080 vertical**

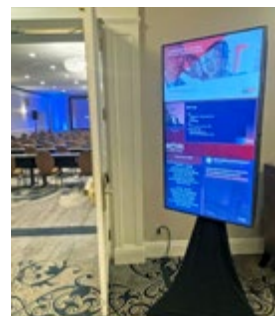

Main Conference Entrance

Registration Area
Roosevelt Ballroom Foyer

General Session Entrance

Crescent Ballroom

Elevator Bank 2

Waldorf Ballroom

Orpheum Ballroom | 3rd Floor

Blue Room | 1st Floor

Mobile App

Reach your strategic targets with precision using this comprehensive digital NCVH resource. Your custom ad will appear on key pages such as home, exhibitor and news.

The NCVH app features real time event agendas, faculty list, exhibitors, important conference information and exclusive offers.

Note: Ads cannot appear on pages where CME content is available.

Exclusive Floating Banner Ad \$10,000

Floating on home, exhibitor, news and abstract pages
1280 x 200 pixels.

Inclusive of all NCVH events
May 26, 2026 - May 29, 2026.

Exclusive Fixed Top Banner Ad \$8,000

Top of home, exhibitor, news and abstract pages
1280 x 200 pixels.

Inclusive of all NCVH events
May 26, 2026 - May 29, 2026.

Overlay (Pop-up) Ad \$7,500

User required to click "close" to continue to app pages
1024 x 768 pixels.

Inclusive of all NCVH events
May 26, 2026 - May 29, 2026.

Exclusive Fixed Bottom Banner Ad \$6,000

Bottom of home, exhibitor, news and abstract pages
1280 x 200 pixels.

Inclusive of all NCVH events
May 26, 2026 - May 29, 2026.

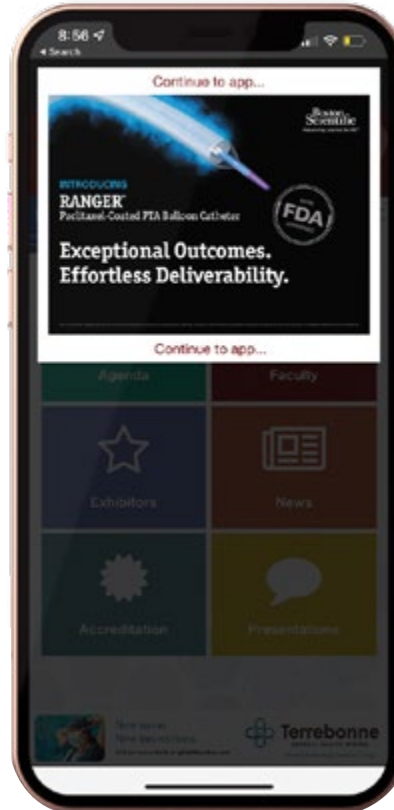
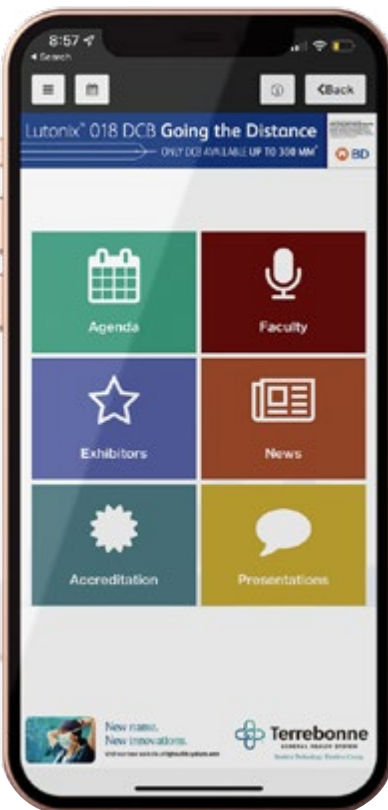

Sponsored Push Notification \$2,500

Push notification with custom sponsor message sent to all NCVH app users at designated times.

Limited to 3 per day.

App Metrics

58% of NCVH attendees across 12 NCVH events downloaded the NCVH app.

During the 2024-2025 conference calendar the NCVH app was accessed 8,000+ individual times.

NCVH app is accessible for all NCVH events.

Email and Social Media Marketing Opportunities



Confirmations and "Know Before You Go" Email Sponsorship \$10,000

Banner ad placement on the confirmation emails to the attendees and faculty members upon confirmation of their registration for the conference and again on the "Know Before You Go" email that outlines the in-person instructions for the conference. This is an exclusive opportunity.

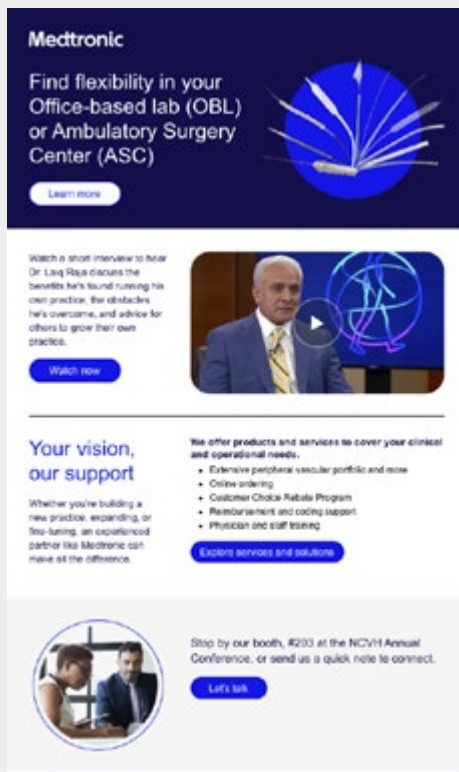

Email Marketing Message \$2,500 per email

One-time email marketing message sent to conference attendees, based on availability.

HTML code and image hosting provided by sponsor.

Formatting Guidelines

- All images contained in email ad **MUST** be hosted on sponsor's server.
- 600 pixels maximum width.
- Responsive web format (recommended).
- Create email ad to include some HTML type, avoid creating entire ad as images (recommended).

Submissions and Scheduling

- Schedule send date by emailing exhibits@ncvh.org; availability is limited.
- Submit code and subject line to exhibits@ncvh.org two weeks prior to email send date.
- Forty (40) characters or less subject line (may require a reference to "NCVH" depending on terms of agreement).
- HTML link (or) text document with HTML code.

Distribution/Reach

- Distribution target: NCVH 2025 past attendees and NCVH 2026 Annual Conference attendees (approximately 2,000 to 2,500 email addresses).
- Distribution demographics are comprised of diverse clinical and non-clinical disciplines including, but not limited to, physicians, allied health, fellows and administrators.

Social Media Post \$2,500

One-time social media post on all NCVH social media platforms. Graphic along with any copy provided by the sponsor. Schedule send date by emailing exhibits@ncvh.org; availability is limited. Approximately 32,000+ combined followers across Facebook, LinkedIn and Twitter.

Recommended graphic size: 1080x1080 pixels

Daily Newspaper

The official daily news of the conference, *What's on the Horizon?* is produced three (3) times on-site during NCVH. Each issue will be available throughout the conference area and placed on seats in the general session each morning. Each issue includes live editorial coverage of educational highlights and photos from throughout the conference.

Placing an ad in *What's on the Horizon?* delivers your message to the entire NCVH community of healthcare professionals – cardiologists, surgeons, podiatrists, family physicians, nurses and allied health professionals.

Purchasing an ad in this daily newspaper also includes:

- Complimentary publication of 300-word press release with each ad placement
- Posting of issues to ncvh.org and distributed via NCVH social media channels and daily emails
- Premium positions available including premium page one banner ad



Size	W x D	1x	2x	3x
Back Cover	8.5" x 11"	N/A	N/A	\$5,400
Inside Front Cover	8.5" x 11"	N/A	N/A	\$4,900
Front Page Strip Ad	7.5" x 2"	N/A	N/A	\$4,700
Two-Page Spread	17" x 11"	\$3,400	\$6,600	\$9,000
Full-Page	8.5" x 11"	\$1,700	\$3,300	\$4,500
Half-Page Vertical	3.5" x 10"	\$1,400	\$2,700	\$3,900
Half-Page Horizontal	7.5" x 5"	\$1,200	\$2,300	\$3,300
1/4 Page	3.5" x 5"	\$800	\$1,500	\$2,100
Postcard Adhered to P1	5" x 7"	\$2,900	\$2,900	\$2,900
Email Banner Ads	530px x 120px	\$750	\$1,400	\$1,800

**Pricing includes 4-color charges. All rates are gross. Appropriate agency commissions apply.*

Digital Advertising

Digital advertising opportunities available in nightly eblasts highlighting conference news and photos that are sent to more than 34,000+ healthcare professionals. Limited banner ad placements available, \$800 per advertisement.

Contact

Jenn Hess

JH Communications LLC | 508.530.2787

Email: jhess@showdailies.com

Deadlines

Space: May 8

Materials: May 15

Conference Bag

Conference bags will be pre-stuffed this year with a conference program and sponsored items. Below is a complete list of available sponsor items that will be pre-stuffed in the conference tote bag that is given to each attendee and faculty member upon check-in.

Conference Bag Logo \$25,000

Exclusive sponsor logo (single color) placement on one side of a heavyweight canvas conference tote pocketed bag. Opposite side will have the NCVH conference logo.



Personal Hand Sanitizer Bottles \$10,000

Custom sponsor logo on side of a mini hand sanitizer bottle. Pre-stuffed in conference bags and on display at the registration desk.

Conference Bag Inserts \$1,500

A sponsored literature piece. Quantity required: 500
Insert Size: May not exceed 8.5" x 11" or 24 pages, unless approved in advance.

Submission deadline: Friday, May 15 (Shipments Received After Due Date May Not be Included in Conference Bag)

Download a shipping label at NCVH.org/sponsors

Promotional Advertising Opportunities

Water Bottle Stations \$30,000

Full color logo sponsorship of water bottle stations placed throughout the conference. Total of six water stations for all three conference days.



Charging Tower \$15,000

- Dual Speakers
- 19" LCD Touchscreen
- Red light indicates occupies locker
- Lockers charge 98% of smart phones
- Custom wraps or decals available
- Steel frame



Name Badge Lanyards \$10,000

Custom lanyards distributed at registration to all conference attendees. Quantity: 1,500

Coffee Cup Sleeves \$15,000

Custom coffee cup sleeves at attendee and faculty coffee stations.

Tri-Sided Table Tents \$10,000

Reinforce top-of-mind brand awareness with these tri-sided table tents placed in strategic, high-traffic conference areas.

Annual Conference Program

Due Date No later than May 1, 2026



Specs:
 8.5" w x 11" h
 4-Color / CMYK
 1/8 (0.125) bleed
 Your final file provided should be 8.75 x 11.25

Back Cover \$15,000
Inside Front Cover \$10,000
Inside Back Cover \$7,000
Divider Ad \$4,500
Full Page Ad \$2,000

Program Inserts \$4,500
 4-color, single sided
 Dimensions 8.25" x 4" plus 1/8" bleed
 Final size should be 8.75" x 4.25"

Ad Template

■ The bleed. Background design should extend here. The ad should include 1/8" bleed on each side. Final submitted ad should measure 8.75" x 11.25"

■ Safe area. Keep all important information inside the blue line to ensure it is not cut off during production.

■ Cut area. The printer will cut along this line. The bleed ensures that there are no white edges included on your ad. Final program size 8.5" x 11"

Note:
 - Hide or delete guides before saving file
 - Save as high resolution PDF, JPEG or PNG
 - Keep all text and important information inside the 'safe area' but extend the design to the 'bleed.'

Hotel Promotional Advertising Opportunities

Hotel Room Key Cards \$25,000

Custom printed key cards for the hotel.

Hotel Room Drop \$12,500

Inside room delivery, host hotel plus overflow.

In-Room Water Bottles \$12,500

Custom labels on water bottles inside host hotel rooms.



TV Remote Wraps \$12,500

Custom printed tv remote control wrap in host hotel rooms.

In-Room Mirror Cling \$12,500

Custom mirror clings in bathrooms of host hotel rooms.



Hotel Room Bag Drop \$8,000

Poly bag on the door, host hotel plus overflow.

Key Card Holders Upgrade \$5,000

Custom key card holders with logo at host hotel.

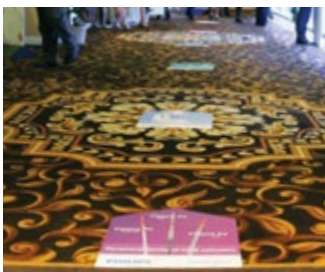

Floor Directional Decals \$15,000

Opportunity to include a full color logo and short message on the floor decals that direct attendee traffic.

Hotel Meeting Room Rental Rates

Let us help you close the deal. NCVH provides the ideal opportunity for exhibitors to conduct private meetings or functions with important decision-makers. Meeting rooms that accommodate most executive needs are available with all of the expected amenities. Large rooms and custom options available. To reserve a room or inquire about availability, call 337-993-7920 or email exhibits@ncvh.org.

View hotel floor plan on page 13

Guidelines

- Requests are subject to review and approval prior to confirmation.
- Food and beverage may be ordered directly from the Roosevelt at cost.
- Standard hotel furnishings included.
- Download the hotel meeting room rental application at NCVH.org/2026-industry
- Cancellation deadline May 1, 2026
- Hourly rental requests will be filled secondary to daily rental requests.

	Theatre	School Room	Banquet	Reception	Conference	Horseshoe	Dimensions	Ceiling	Sq Footage	Level	Min Rental	Rate
Prytania Room	20	12	20	N/A	10	N/A	24x12	9'2"	288	Second	4 hours	\$250/hour
Saenger Room	18	12	16	N/A	10	N/A	21x12	8'	252	Second	4 hours	\$250/hour
Huey P. Long Exec. Boardroom	N/A	N/A	N/A	N/A	12	N/A	38x15	10'	570	Second	1 hour	\$150/hour
Producer's Room	25	20	30	N/A	18	N/A	27x15	8'4"	405	Second	2 hours	\$250/hour
Director's Room	25	20	30	N/A	18	N/A	27x15	8'4"	405	Second	2 hours	\$250/hour
Lafitte Room	60	36	50	65	20	20	35x17	13'8"	595	Mezzanine	4 hours	\$400/hour
Napoleon Room	50	30	40	55	18	18	34x17	13'8"	578	Mezzanine	3 days	\$4,000/day
Bienville Room	60	36	50	60	20	20	31x29	11'	899	Mezzanine	3 days	\$5,000/day

Orpheum Theater Advertising Opportunities

Custom Koozie \$12,000

Include your company logo on a koozie that will be distributed at the 27th Annual Event. The NCVH logo will be on the opposite side.

Theater Now Showing Signage \$5,000

Three playbills located on the outside of The Orpheum Theater, facing The Roosevelt Hotel entrance. Custom design provided by sponsor. Final design dimensions must be 33.5in x 67.5in with a 3in bleed on all sides.



Custom Barricade Covers \$5,000 each

Full color, double-sided custom barricade covers outside of The Orpheum Theater entrance.

Logistics

Official Contractors

Freeman Exhibitor Services Department

US or Canada: 888.508.5054

International: 817.210.4869

Email: exhibitorsupport@freeman.com

Pre-Show FAQ: freemanco.com/preshowFAQ

Post-Show FAQ: freemanco.com/postshowFAQ

Freeman Shipping Address

905 Sams Ave. | New Orleans, LA 70123

Warehouse Receiving Start - Monday, April 27

Furnishings Advance Pricing Deadline - Wednesday, April 29

Warehouse Receiving Deadline - Monday, May 18

Shipments received after May 20 subject to late fees

Download the NCVH 2026 exhibitor kit at ncvh.org/industry

Electrical and Internet

Royal Productions

Ph: 504.335.3118

Email: eventtechnology@royalproductions.com

Download the electrical and internet form at

NCVH.org/industry

Hotel Shipping Address

The UPS Store / The Roosevelt New Orleans

Attn: NCVH 2026

Booth # _____

Piece # ____ of ____

Contact Name _____

130 Roosevelt Way | New Orleans, LA 70112

Audiovisual Services, Video Recording and Presentation Management

M3Meet

301 Mecca Street

Lafayette, LA 70508

Ph: 904.513.1370

Email: sales@m3meet.com

Exhibit Hall and Booth Specifications

Carpeting

Exhibit hall has existing hotel carpet.

Custom carpet available for purchase, but not required.

Drape

8' vertical black back drape

3' vertical black side dividers

Lead Retrieval

American Tradeshow Services

217 General Patton Avenue

Mandeville, LA 70471

Ph: 985.809.0600

Email: exhibitorsales@american-tradeshow.com

Other

Chairs, tables and waste baskets **NOT** included

7" x 44" one-line identification sign provided

Download the lead retrieval order form

at NCVH.org/industry

Exhibit Rules and Regulations

The exhibit hall is an important extension of the education offered at NCVH. It is an opportunity for healthcare providers to learn about the most up-to-date products and services available. NCVH reserves the right, even if an application has been approved, to refuse exhibits, curtail activities or close exhibits or parts of exhibits that do not, in NCVH's sole determination, comply with its rules and regulations.

By submitting an application to exhibit and sponsor the NCVH annual meeting, companies agree to the following:

Policies

New Cardiovascular Horizons Foundation, a 501(c)(3) nonprofit organization, is proud to present the 2026 New Cardiovascular Horizons (NCVH) 27th Annual Conference. We are committed to providing quality, unbiased medical education and follow all ACCME, AdvaMed and PhRMA guidelines.

Items listed in this industry prospectus, including exhibit booths, are considered promotional, marketing and/or advertising for participating companies and organizations.

We sincerely appreciate all educational grants received, however, grant funding can only be used for educational expenses. ACCME policy states educational grants (commercial support) cannot be used for anything of promotional value, which includes the items listed in this industry prospectus.

We strive to make NCVH a valuable investment. Flexible packages are available to assist supporters in reaching their target audience and marketing goals.

Guidelines

- Signed application and deposit required to reserve space
- Full payment must be received prior to move-in
- Exhibit required to qualify for additional support opportunities
- Final attendee list will NOT be provided to exhibitors who move out prior to published move-out time

Name Badges and Company Profile

Register for your exhibitor badges and update company profiles (description, logo and company URL) in the Exhibitor Service Center. Login at [NCVH.org/login](https://ncvh.org/login), and select the "View Exhibitor Service Center" link next to NCVH 2026 Annual Conference. Exhibitor company profiles and complimentary exhibitor badges must be pre-registered by May 1.

Badges in excess of package or booth purchase:

- \$399 per badge registered before May 1
- \$699 per badge registered after May 1

Ad and Logo Specifications

- Full page ad(s) specifications are 8.5" W x 11" L with a 0.125" bleed. Final submitted ad size should be 8.75" x 11.25"
- No trim marks should be saved on the file.
- All ad files must be a high-resolution four-color process PDF for the program or html for sponsored emails.
- Send all ads to exhibits@ncvh.org by publish deadline (May 1, 2026).

Eligibility

- All products marketed and promoted that are regulated by the Food and Drug Administration (FDA) must meet FDA guidelines or be FDA approved.
- Industry sponsors who, in the sole opinion of NCVH, conduct themselves unethically may be dismissed from the meeting and exhibit area without refund or may be prohibited from attending and/or exhibiting in the future.
- Upon submitting an application, the industry sponsor agrees that the information contained in this industry prospectus is an integral and binding part of the exhibit space contract and that it is the responsibility of the industry sponsor to distribute information to all individuals from the company attending NCVH.

Terms of Payment

1. Before March 1, a 50% deposit must accompany the industry supporter application and contract. The balance is due March 31.
2. At its discretion, NCVH may elect to agree to payment terms that vary from what is outlined in these rules and regulations. Please contact exhibits@ncvh.org if special payment terms are needed.
3. Payments can be made by check, credit card, echeck or wire transfer.
 - a. Checks: All checks must be payable to NCVH Foundation.
 - b. eCheck: Contact exhibits@ncvh.org for instructions. No processing fee.
 - c. Credit Cards: Visa, MasterCard, Discover, and American Express are accepted for payment. Please note all credit card payments are subject to a non-refundable 3% processing fee. Contact exhibits@ncvh.org for a credit card authorization form.
 - d. Wire transfers: Contact exhibits@ncvh.org for instructions. The industry sponsor must pay any wire transfer fees.

Cancellation or Reduction of Exhibit Space

If an industry sponsor wishes to cancel or reduce its exhibit space at the NCVH conference, notification must be given in writing to: **Brittany Alexander · 301 Mecca Street · Lafayette, LA 70508 · exhibits@ncvh.org**

1. NCVH is committed to holding its Annual Conference in New Orleans May 26 - 29, 2026. All NCVH 2026 educational content will be archived and presented as enduring material.
2. If an industry sponsor cancels or reduces its commitment after April 10, 2026 the industry sponsor will pay as liquidated damages 100% of the total contract fees.
3. If an industry sponsor fails to pay 100% of the total contracted fees by April 27, 2026 NCVH will cancel the sponsor's participation and is free to assign the released space and promotional opportunities (if applicable) to other companies. Cancellation of participation does not release the industry sponsor from its obligation to pay 100% of the total contracted fee.

No-Show Policy

Any exhibit unoccupied by 6 a.m. on Wednesday, May 27 may be regarded as a "no-show." The industry sponsor will have been deemed to have canceled the exhibit space contract, and, as such, the exhibitor will pay as liquidated damages 100% of the total contracted fees. All freight will be removed from the exhibitor's booth and returned to the loading dock at the industry sponsor's expense, and NCVH will be free to assign the space to other exhibiting companies or utilize the space at its discretion.

Miscellaneous

Once signed by the industry sponsor and NCVH, the application and contract is irrevocable, and the rights of NCVH under this contract shall not be deemed waived except as specifically stated in writing by an authorized representative of NCVH. The industry sponsor further agrees that on acceptance of this agreement by NCVH, with or without appropriate or timely payments of any and all fees, this agreement shall be binding and enforceable in accordance with its terms. The Contract will be binding on the exhibitor's and NCVH's successors. If any term, clause or provision hereof is held invalid or unenforceable by a court of competent jurisdiction, such invalidity shall not affect the validity or operation of any other term, clause or provision, and the invalid term, clause or provision shall be deemed to be severed from the agreement.

Applicable Law

Any claim or cause of action arising out of this agreement shall be governed exclusively by the law of the State of Louisiana without regard to its conflict of laws principles. Any claim or cause of action arising under this agreement shall be adjudicated exclusively in the local or federal courts of State of Louisiana. The industry sponsor hereby submits to the personal jurisdiction of the courts located in the State of Louisiana.

Amendments

These Rules and Regulations may be amended at any time by NCVH, and all amendments so made shall be binding on industry sponsors equally with the original rules and regulations.

Indemnification

Each industry sponsor, in making application for participation, agrees to protect, indemnify and hold harmless the following parties (including, but not limited to): New Cardiovascular Horizons Foundation; M3Meet, LLC; The Roosevelt Hotel, New Orleans; Freeman and their officers, directors, agents, contractors and employees from any and all claims, liability, damages or expenses asserted against them or incurred by them as a result of, or in connection with, any loss of or damage to property, or injury to persons resulting from, arising out of or in any way connected with the negligence, wrongful acts of or breach of contract by the industry sponsor or its agents, servants or employees.

Liability and Insurance

NCVH shall in no event be liable to an industry sponsor for any lost business opportunities or for any other type of indirect, consequential or other type of damages alleged to be due from a breach of this contract or other arising under this agreement or in connection with NCVH 2026. It is understood and agreed that the sole liability of NCVH to the industry sponsor for any breach of this contract or for any other cause of action under any theory of liability arising under this agreement or in connection with NCVH 2026 shall be limited to refund of all amounts paid by the exhibitor or NCVH pursuant to this contract as an exclusive remedy.

The industry sponsor shall, at sole cost and expense, procure and maintain through the term of this contract comprehensive general liability insurance against claims for bodily injury or death and property loss or damage occurring in or upon or resulting from the premises leased by NCVH.

NCVH will bear no liability for personal injuries, whether suffered by an industry sponsor, its employees, its contractors, agents or business invitees. NCVH will also assume no liability for loss or damage to the property of an exhibitor, its employees, its contractors, agents or business invitees, regardless of the cause, unless such injury or damage results from, or is caused directly or exclusively by, the negligence or wrongful acts of NCVH.

Non-Discrimination Policy

NCVH is committed to hosting a tolerant and diverse conference where everyone feels welcome, thereby prohibiting discrimination based on age, race, color, creed, religion, ancestry, disability, national origin, sex, gender identity, gender expression, sexual orientation, marital status, veteran status, and any other basis protected by federal, state, or local law.

Use of Exhibit Space

Alcoholic Beverages

The sale, consumption, distribution or storage of alcoholic beverages in exhibit booths is not permitted at any time.

Clinical Testing

Industry sponsors are permitted to conduct appropriate and relevant clinical tests provided such activity is disclosed, in writing, to NCVH before May 1.

Demonstration and Promotional Presentations

Industry sponsors may conduct demonstrations and/or promotional presentation from their exhibit booth. Examples include, but are not limited to, case studies and physician presentations related to a company's product or service. As a reminder, CME activities are not permitted in the exhibit hall.

Distribution of Materials

Distribution of printed materials (including promotional materials, publications, satellite event invitations/announcements and books) is limited to the company's exhibit booth unless otherwise provided for by NCVH.

Food and Beverages

Industry sponsors are permitted to serve and/or distribute food and non-alcoholic beverages in their exhibit booths during all exhibit hours. Selections may include individual wrapped candy, chocolates or mints as well as selections from the catering menu available at The Roosevelt Hotel.

Giveaways

Industry sponsors may provide giveaways that are educational in nature and modest in value. NCVH encourages companies to check with their own medical affairs/compliance staff for guidelines adhered to by their own companies.

Fellows Course (pg 7)

<input type="checkbox"/> Fellows and Hands-on Workshops	\$40,000
<input type="checkbox"/> Lunch	\$25,000
<input type="checkbox"/> Dinner	\$25,000
<input type="checkbox"/> Breakfast	\$25,000
<input type="checkbox"/> Fellows Text Messaging	\$2,000

Business of Medicine (pg 8)

<input type="checkbox"/> Meet the Titans Reception	\$10,000
<input type="checkbox"/> Lunch Symposium	\$10,000
<input type="checkbox"/> Breakfast Symposium	\$10,000

Premier Sponsor Packages (pg 9)

<input type="checkbox"/> Platinum	\$210,000
<input type="checkbox"/> Gold	\$160,000
<input type="checkbox"/> Silver	\$110,000
<input type="checkbox"/> Bronze	\$60,000

In-Person Exhibits (pg 10)

<input type="checkbox"/> 10 x 10	\$23,000
<input type="checkbox"/> 8 x 10	\$13,000
<input type="checkbox"/> 8 x 8	\$6,500
<input type="checkbox"/> Publishers	\$1,500
<input type="checkbox"/> Non-profits	\$500

Meal Symposia (pg 11)

<input type="checkbox"/> Breakfast	\$ _____
<input type="checkbox"/> Lunch	\$ _____
<input type="checkbox"/> Symposium Live Case Upgrade	\$ _____
<input type="checkbox"/> Symposium Live Stream Broadcast	\$5,000
<input type="checkbox"/> Symposium Video Recording	\$2,000

High Traffic Signage (pg 14)

<input type="checkbox"/> Multi-Area Column Wrap	\$25,000
<input type="checkbox"/> Grand Entrance Column Wrap	\$15,000
<input type="checkbox"/> Conference Wi-Fi	\$12,000
<input type="checkbox"/> Staircase Multi-View Signage	\$12,000
<input type="checkbox"/> Cloth Banner Hang	\$10,000

Digital Display Opportunities (pg 15)

<input type="checkbox"/> Exhibit Hall Video Ad	\$5,000
<input type="checkbox"/> Lecture Branding	\$5,000
<input type="checkbox"/> Digital Signage Looping Ad	\$2,500

Mobile App (Pg 16)

<input type="checkbox"/> Exclusive Floating Banner Ad	\$10,000
<input type="checkbox"/> Exclusive Fixed Top Banner Ad	\$8,000
<input type="checkbox"/> Overlay (Pop-Up) Ad	\$7,500
<input type="checkbox"/> Exclusive Fixed Bottom Banner Ad	\$6,000
<input type="checkbox"/> Sponsored Push Notification	\$2,500 x _____

Email Marketing Opportunities (pg 17)

<input type="checkbox"/> Know Before You Go Email	\$10,000
<input type="checkbox"/> Email Marketing Message	\$2,500 per email
<input type="checkbox"/> Social Media Post	\$2,500

Conference Bag (pg 19)

<input type="checkbox"/> Conference Bag Logo	\$25,000
<input type="checkbox"/> Personal Hand Sanitizer Bottles	\$10,000
<input type="checkbox"/> Conference Bag Inserts	\$1,500 x _____

Promotional Opportunities (pg 20)

<input type="checkbox"/> Water Bottle Stations	\$30,000
<input type="checkbox"/> Charging Tower	\$15,000
<input type="checkbox"/> Coffee Cup Sleeves	\$15,000
<input type="checkbox"/> Name Badge Lanyards	\$10,000
<input type="checkbox"/> Tri-Sided Table Tents	\$10,000

Conference Program (pg 21)

<input type="checkbox"/> Back Cover	\$15,000
<input type="checkbox"/> Inside Front Cover	\$10,000
<input type="checkbox"/> Inside Back Cover	\$7,000
<input type="checkbox"/> Tab Ad	\$4,500
<input type="checkbox"/> Program Inserts	\$4,500
<input type="checkbox"/> Full Page Ad	\$2,000

Hotel Promotional Opportunities (pg 22)

<input type="checkbox"/> Hotel Room Key Cards	\$25,000
<input type="checkbox"/> Floor Directional Decals	\$15,000
<input type="checkbox"/> Hotel Room Drop Inside Room	\$12,500
<input type="checkbox"/> In-Room Water Bottles	\$12,500
<input type="checkbox"/> TV Remote Wraps	\$12,500
<input type="checkbox"/> In-Room Mirror Cling	\$12,500
<input type="checkbox"/> Hotel Room Drop Poly bag on Door	\$8,000
<input type="checkbox"/> Key Card Holders Upgrade	\$5,000

Orpheum Theater Advertising Opportunities (pg 24)

<input type="checkbox"/> Custom Koozie	\$12,000
<input type="checkbox"/> Theater Now Showing Signage	\$5,000
<input type="checkbox"/> Custom Barricade Covers	\$5,000 x _____

Industry Sponsor Application and Contract

Please complete entire application. This application becomes a binding contract upon submission.

Contact Information

Company Name _____
(As it will appear online and in on-site materials)

Street Address _____

City _____ State _____ Zip _____

First Name _____ Last Name _____

Phone _____ Email _____

Signature _____

Payment Information

Upon receipt of application, an invoice will be sent to the email address provided above with online credit card and eCheck payment options. **Payments must be received prior to the meeting date; move-in will not be permitted without final payment.**

NCVH Foundation is a 501(c)(3) non-profit organization. Tax ID 46-3186713. An NCVH W9 is available for download at NCVH.org/sponsor.

Credit Cards

All major credit cards accepted.
3% processing fee

Meeting Location

The Roosevelt New Orleans
130 Roosevelt Way
New Orleans, LA 70112
Ph: 844.373.2130

eChecks

No processing fee

Checks

Make payable to "NCVH Foundation"
Mail to: New Cardiovascular Horizons
1750 Martin Luther King Jr. Blvd
Ste 109 - Box 253
Houma, LA 70360

Exhibit Support

exhibits@ncvh.org
Ph: 337.993.7920 | Fax: 337.993.7922



New Cardiovascular Horizons

301 Mecca Street
Lafayette, LA 70508

337.993.7920
exhibits@ncvh.org